

Whistlestop Marathon

Iron River, WI to Ashland, WI

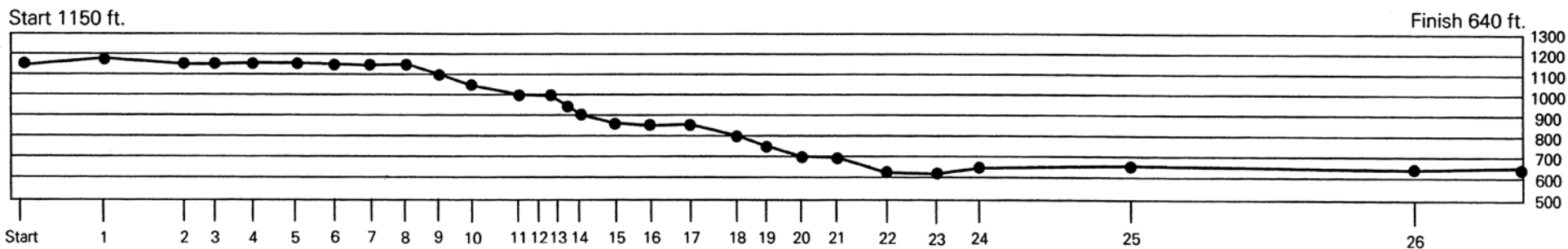

• Course Map and Elevation Chart •

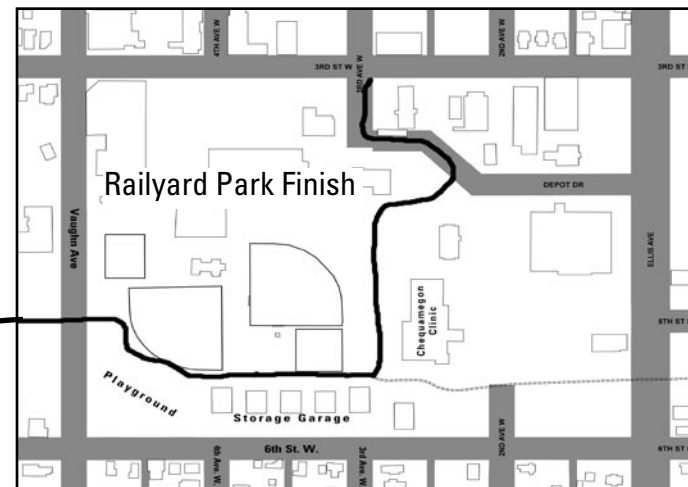
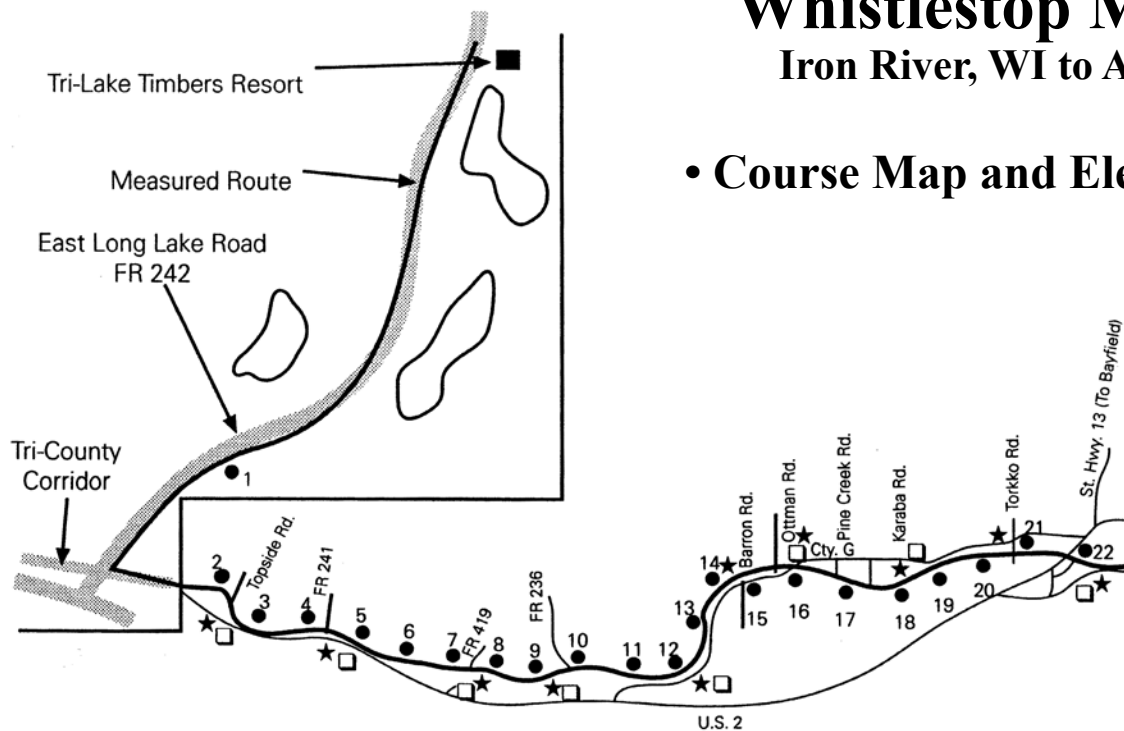

Whistlestop Marathon Aid Stations. Porta Potties & Recommended Spectator Points

Start: ★ □ SP (limited parking)

- 1. Topside Road (2.5 mi): ★ □ SP
- 2. FR 241/Pumping Station Road (4.75 mi): ★ □ SP
- 3. FR 419/Spider Lake Road (7.9 mi): ★ □
- 4. FR 236/Ino Road (9.9 mi): ★ □ SP
- 5. Smerchik Road (12.7 mi): ★ □
- 6. Barron Road (14.6 mi): ★ SP
- 7. Moquah Town Park (16.0 mi): ★ □ SP

- 8. Karaba Road (18.0 mi): ★ □
- 9. Torkko Road (20.6 mi): ★ SP
- 10. Experiment Farm (21.6 mi): ★ □ SP
- 11. Golf Course Road #1 (22.9 mi): ★
- 12. Golf Course Road #2 (23.7 mi): ★ SP
- 13. 17th Ave. West (25.0 mi): ★ □ SP
- Finish: ★ □ SP

★ = Aid Station □ = Porta Potty SP = Recommended Spectator Point

Spectator Tips: Please be very cautious when approaching spectator points. Do not cross corridor/course when runners are present. Park as far off the road as possible. Be courteous to other spectators. Allow yourself plenty of time.

Whistlestop Marathon

Iron River, WI to Ashland, WI

• Course Map and Elevation Chart •

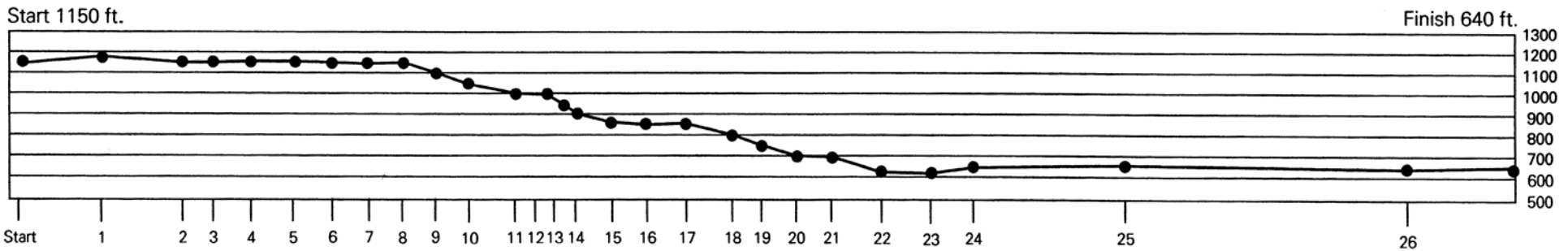
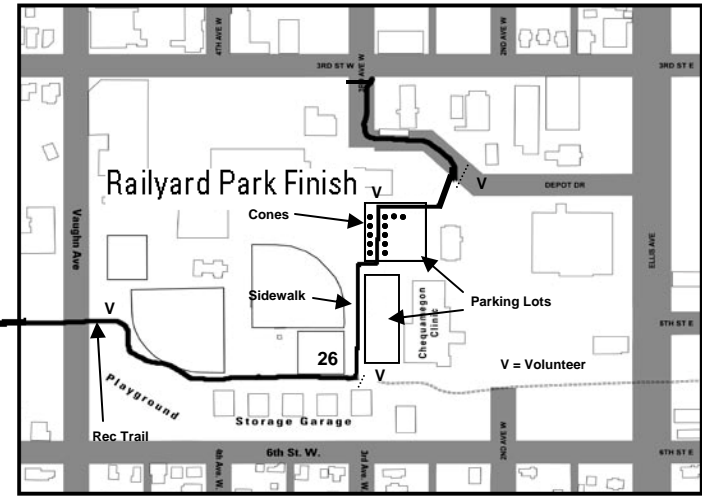
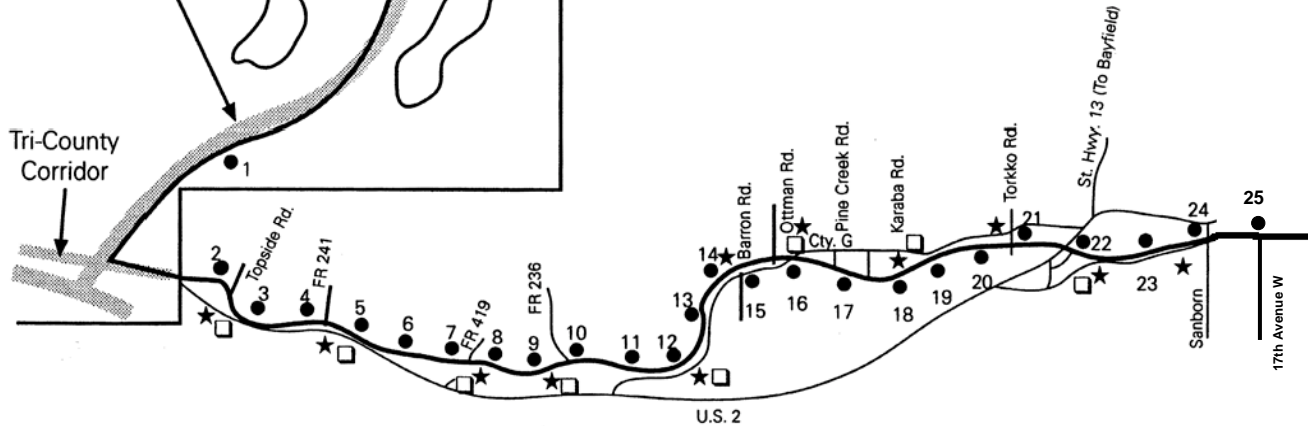
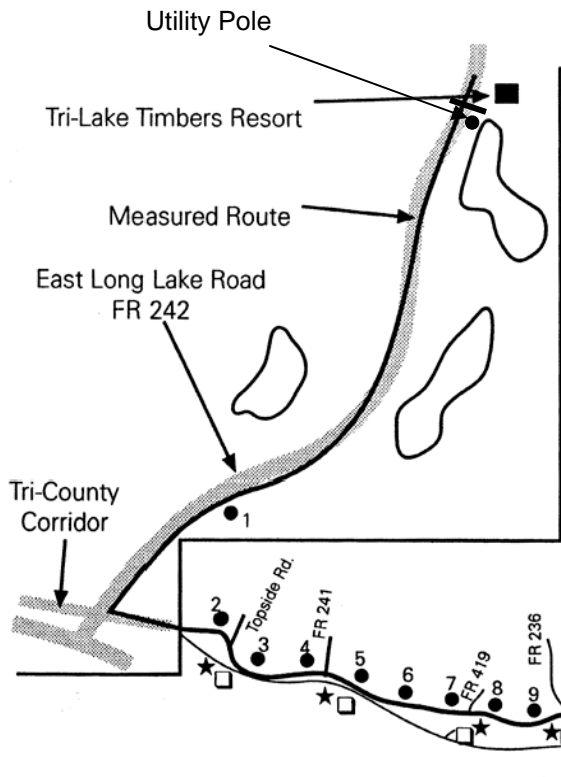

WHISTLESTOP MARATHON START

43' 12" north of center point of transformer utility pole immediately south of south entrance to Tri-Lakes Timber Resort on East Long Lake Road in the Township of Iron River, Wisconsin

WHISTLESTOP MARATHON FINISH

First curb crack south of street light pole on the SW corner of the intersection of 3rd Street W and 3rd Avenue W in the City of Ashland. The crack is also 4ft 3 in south of pole.



Whistlestop Half-Marathon

Moquah, WI to Ashland, WI

• Course Map and Elevation Chart •

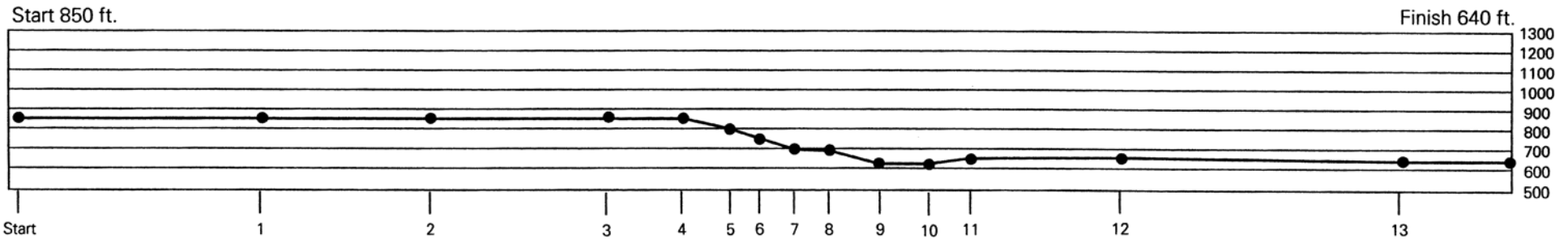
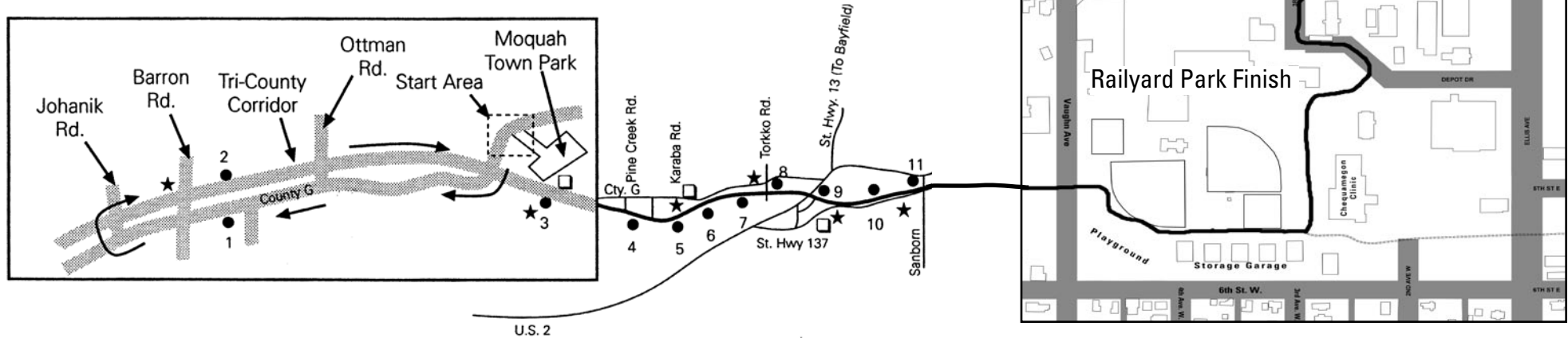

WhistleStop Half- Marathon Aid Stations, Portapotties & Recommended Spectator Points

Start: ★ □ SP

- 1. Barron Road (14.6 mi): ★ SP
- 2. Moquah Town Park (16.0 mi): ★ □ SP
- 3. Karaba Road (18.0 mi): ★ □
- 4. Torkko Road (20.6 mi): ★ SP
- 5. Experiment Farm (21.6 mi): ★ □ SP

- 6. Golf Course Road #1 ((22.9 mi): ★
- 7. Golf Course Road #2 (23.7 mi): ★ SP
- 8. 17th Ave. West (25.0 mi): ★ □ SP
- Finish: ★ □ SP

★=Aid Station □=Porta Potty SP=Recommended Spectator Point

Spectator Tips: Please be very cautious when approaching spectator points. Do not cross corridor/course when runners are present. Park as far off the road as possible. Be courteous to other spectators. Allow yourself plenty of time.